

31/275 Harlequin Mask Arch Instructions

©2010 Oriental Trading Company, Inc.
orientaltrading.com (800)-228-2269

COMPONENTS LIST

QTY: 2	A) Top Post
QTY: 2	B) Bottom Post
QTY: 2	C) Angle Brace
QTY: 2	D) Angle Extension
QTY: 2	E) Small Brace
QTY: 4	F) Plug
QTY: 6	G) Straps
QTY: 2	H) Small Gold Brace
QTY: 1	I) Mask Banner

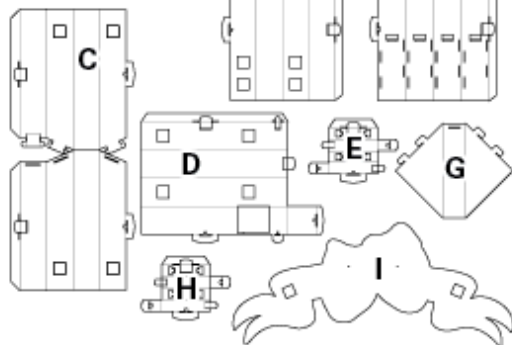
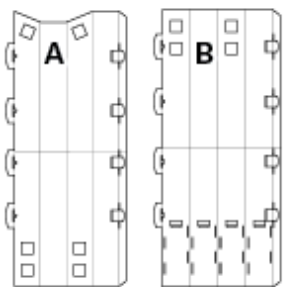

BEFORE YOU BEGIN ASSEMBLY:

- Check that all materials are included in your kit.
- Please read through the material before you begin assembly.
- It is a fact that your work will be completed in 30 to 60 minutes for 2 people.
- Assembly time should be about 30 to 45 minutes to one hour for 2 people.

F

STEP 1:

Fold each Top Post (A) along the score line to form a long box shape with the pointed side facing out. Fold the shape secondarily meeting the large and small tabs into the slit opening.

Repeat Step 1 to make a total of two Top Posts (A).

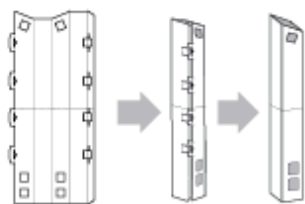

STEP 2:

Fold each Bottom Post (B) along the score line to form a long box shape with the pointed side facing out. Fold the shape secondarily meeting the large and small tabs into the slit opening.

Repeat Step 2 to make a total of two Bottom Posts (B).

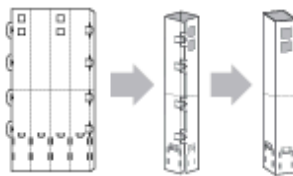

STEP 3:

Repeat the four fold at the bottom of each side of the Bottom Post (B).

Repeat Step 3 on each of the Bottom Posts (B).

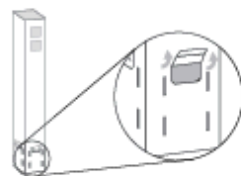

STEP 4:

Roll each Small Brace (E) and Small Gold Brace (H) along the score line to form a long box shape with the pointed side facing out. Fold the shape secondarily meeting the large and small tabs into the slit opening.

Roll the top of bottom of the post by rolling the top tabs into the opening.

Repeat Step 4 on the total of 6 Small Braces (E) and 6 Small Gold Braces (H).



STEP 5:

Place one of the Top Posts (A) into the top opening of the Bottom Post (B) making sure that the two top tabs meet on each side.

Repeat Step 5 to make a total of two Arch Posts.



BEFORE BEING PLACED ON THE BOTTOM OF AN ARCH POST THE SMALL GOLD BRACE AND PLUG ARE JOINED.

STEP 6:

Place two of the Small Braces (E) into the two openings found in the side of the Arch Post (A). The Small Braces (E) should go all the way through to the bottom of the Arch Post (A) by sliding out of the newly created slot.



STEP 7:

Pop the tabs out of the end of the Small Brace (E) will give you a stronger support for the post.

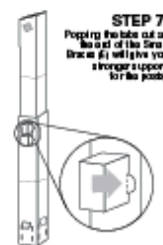

STEP 8:

Roll three Straps (G) along the score line to form a long box shape and then insert them into the large slit opening at the base of the Bottom Post (B). Make sure to leave the tab on the Bottom Post (B) exposed in the opening.

Repeat Step 8 on each of the Lower Posts.



STEP 9:

Fold the tabs found on the Bottom Post (B) into the open slit found at the top of the Brace (E).

This will lock the support into place making the post sturdy.



Important: The Small Gold Brace (H) should be placed on each of the sides of the Bottom Post (B) except the side of the Bottom Post (B) that is at the base. The Small Gold Brace (H) will lock out of the end of the post.

STEP 10:

Fold the Angle Extension (D) along the score line to form a long box shape with the pointed side facing out. Fold the shape secondarily meeting the large and small tabs into the slit opening.

Roll the top of the brace by meeting the top tabs into the slit opening.

Repeat Step 10 to make a total of two Angle Extensions (D).

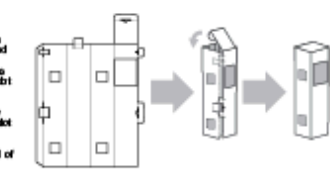

STEP 11:

Slide the top of the bottom of the Angle Brace (C) into the opening of the Arch Post (A) making sure that the two top tabs meet on each side.

Repeat Step 11 to make a total of two Arch Posts.

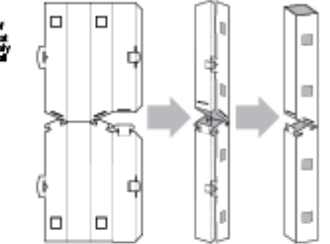

31/275 Harlequin Mask Arch Instructions

©2010 Oriental Trading Company, Inc.
orientaltrading.com (800)-228-2269

STEP 12:

Fold the outside flaps of each tab found in the center of the Angle Brace (C) inward as shown in #1. Fold each tab out and pull the two tabs together as shown in #2. Place each tab into the opening as shown in #3. The small tabs of each side of the Angle Brace (C) will fit into the slit opening of the Arch Post (A).

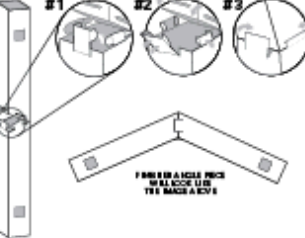

STEP 13:

Connect the Angle Extension (D) pieces to the Arch Post (A) into the opening by sliding up each end of the piece. Make sure that the large opening found on the Angle Extension (D) piece faces down when connecting these two pieces.

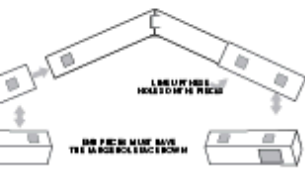

STEP 14:

Use the two Small Gold Braces (H) to join the Angle Brace (C) two of the Small Gold Braces (H) should go in the middle hole that is located between the Angle Brace (C) and the Angle Extension (D).

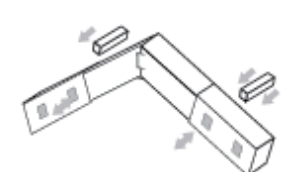

HELPFUL HINT:

• This process will need the help of at least two to three people.

STEP 15:

Use the top of two of the other Arch Posts (A) and place each side of the Arch Post (A) on each of the corners of the post. One post will fit into each opening found on the bottom of each corner of the arch. The angled opening found on the top of each Arch Post (A) will fit into the angled opening found at each corner of the arch.

Place the Arch Posts (A) at an angle to meet the top.

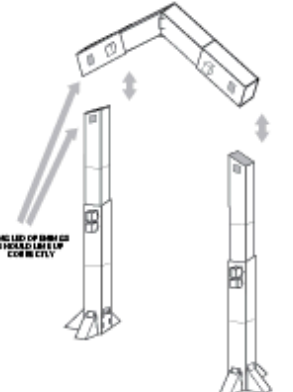

STEP 16:

Slide the remaining two Small Braces (E) into the top opening found on the Arch Post (A). This process will have the Small Braces (E) go through the arch and the posts will form the arch structure.

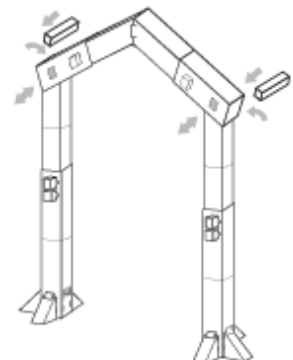

STEP 17:

Place the Mask Banner (I) over the Small Gold Brace (E) and hook the Mask Banner (I) in place on the Arch.

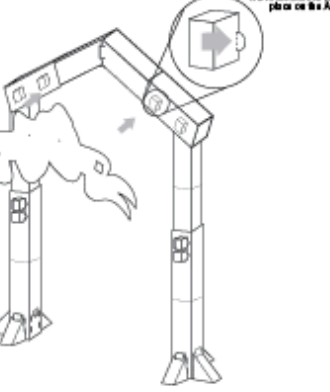

Your Harlequin Mask Arch is Finished!

Have fun with your new Arch! Decorate with lights, leather boots, or other things you may want! But the Arch display places are just a start.

WARNING!!!
THE ARCH IS NOT CAPABLE OF SUSTAINING HEAVY WEIGHTS.

ARCH SHOULD NOT BE USED IN THE RAIN OR OTHER WEATHER THAT MAY CAUSE DAMAGE TO THE GARLAND.

